

STAINLESS STEEL

# Self - Priming Jet Pumps

JT SERIES



## DESCRIPTION

C.R.I. Self-Priming Jet pump's casing and ejector unit are designed carefully to give the best possible hydraulic efficiency and suction lift characteristics. Mechanical seals are made of carbon & ceramic which is precisely grounded to close tolerances. Shaft is made of quality steel & precisely grounded to ample size for transmitting the rated horse power, without any transmission loss. Most modern and highly sophisticated machinery and technology are employed in the manufacture of these pumps using quality raw materials & dynamically balanced impellers, rotors & shafts ensure longer life and noise free operation. The JTS series pumps are made of complete stainless steel construction which are more suitable for potable water.

## SPECIFICATIONS

|                                    |   |   |
|------------------------------------|---|---|
| Power Range                        | : | JTS : 0.37 kW - 1.1 kW   JTB : 0.45 kW - 1.5 kW   |
| Speed                              | : | 2900 rpm  |
| Degree of Protection               | : | IP 55 / IP 44   |
| Class of insulation                | : | "F" / "B"   |
| Versions                           | : | Single phase - 230V, 50Hz A.C. supply (Permanent Split Capacitor-PSC)<br>Incorporated with thermal overload protector<br>Three phase - 380-415V, 50Hz A.C. supply |
| Direction of Rotation              | : | Clock wise viewed from driving end  |
| Type of Duty                       | : | S1 (Continuous)   |
| Nominal Suction and Delivery Sizes | : | 1" x 1", 1¼" x 1" (BSP)   |

## MATERIALS OF CONSTRUCTION

|                 | <b>JTS</b>         | <b>JTB</b>                  |
|-----------------|--------------------|-----------------------------|
| Pump Casing     | : S.S 304          | Cast Iron                   |
| Motor Frame     | : Aluminum         | Aluminum                    |
| Impeller        | : S.S 304          | Bronze / Brass / Aluminium* |
| Shaft           | : S.S 304          | S.S 304                     |
| Mechanical Seal | : Carbon & Ceramic | Carbon & Ceramic            |

## PUMP OPERATING LIMITS

|                             |                   |
|-----------------------------|-------------------|
| Maximum Head                | : 48.5 m / 159 ft |
| Maximum Suction lift        | : 7 m             |
| Maximum liquid Temperature  | : +5°C ~ +60°C    |
| Maximum Ambient Temperature | : 50°C            |

## FEATURES

- High operating efficiency resulting in lower power consumption.
- Good suction lift characteristics.
- Dynamically balanced rotating parts.
- Balanced and rigid construction.
- Inbuilt thermal overload protector in all single phase pumps.

## APPLICATIONS

Residential, Irrigation, Small Farms, Pressure Boosting Units, Industrial Water Supply, Washing System, Food Processing Industries.

\* For Aluminium impeller pump models the third digit of the model name will be replaced with "A".

PERFORMANCE CURVES

JT SERIES

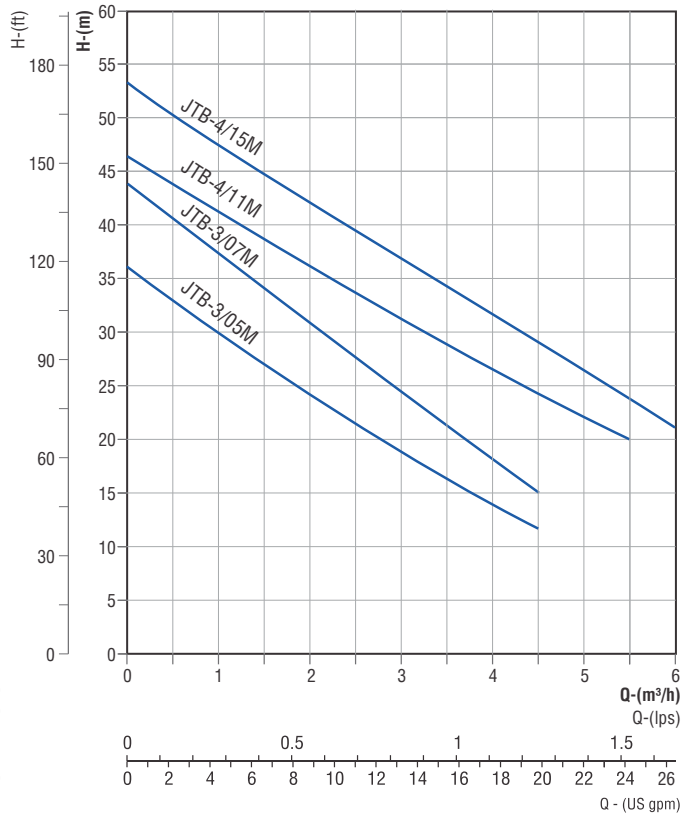
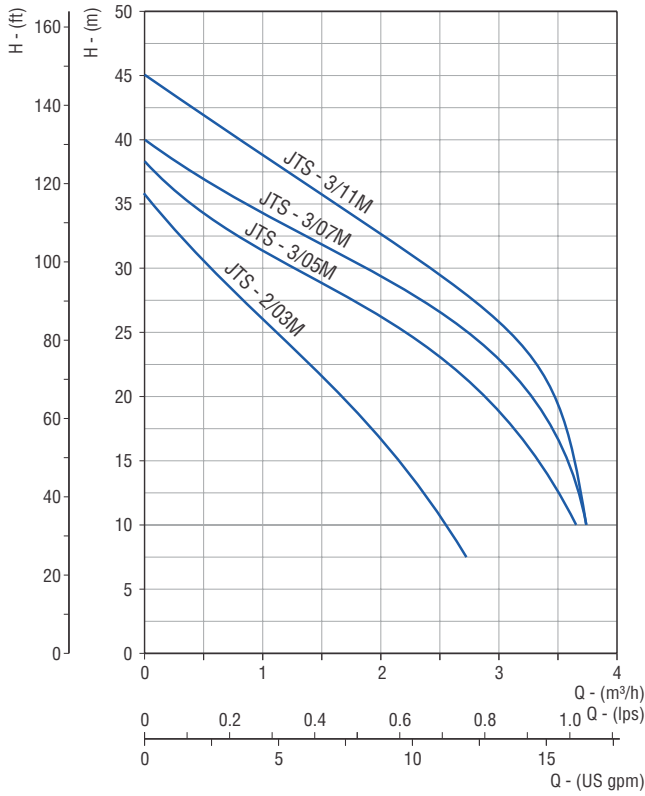

PERFORMANCE CHARTS

| PUMP MODEL |           | MOTOR POWER |      | RATED CURRENT(A) |          | NOMINAL PUMP SIZE IN INCHES (Suc x Del) | DISCHARGE IN lps / m³/h |     |      |      |      |      |              |      |              |
|------------|-----------|-------------|------|------------------|----------|---|-------------------------|-----|------|------|------|------|--------------|------|--------------|
|            |           |             |      |                  |          |   | 0                       | 0.1 | 0.3  | 0.4  | 0.6  | 0.7  | 0.8          | 1.0  | 1.04         |
| 230V       | 380V      | KW          | HP   | 1Ph 230V         | 3Ph 380V |   | 0                       | 0.5 | 1    | 1.5  | 2    | 2.5  | 3            | 3.5  | 3.75         |
| JTS-2/03M  | JTS-2/03T | 0.37        | 0.5  | 3.1              | 0.93     | 1 x 1                                   | TOTAL HEAD IN METRES    |     |      |      |      |      |              |      |              |
|            |           |             |      |                  |          |   | 36                      | 31  | 26.5 | 21.5 | 17   | 11   | 7 (2.75m³/h) | -    | -            |
| JTS-3/05M  | JTS-3/05T | 0.55        | 0.75 | 4.3              | 1.49     | 1 x 1                                   | 38                      | 34  | 31.5 | 28.5 | 26.5 | 23   | 18.5         | 12.5 | 10 (3.7m³/h) |
| JTS-3/07M  | JTS-3/07T | 0.75        | 1.0  | 4.5              | 1.63     | 1 x 1                                   | 40                      | 37  | 34   | 32   | 29   | 26.5 | 23           | 17   | 10           |
| JTS-3/11M  | JTS-3/11T | 1.1         | 1.5  | 5.3              | 2.65     | 1 x 1                                   | 45                      | 42  | 38.5 | 36   | 32.5 | 29.5 | 26.5         | 19.5 | 10           |

| PUMP MODEL |           | MOTOR POWER |      | RATED CURRENT(A) |          | NOMINAL PUMP SIZE IN INCHES (Suc x Del) | DISCHARGE IN lps / m³/h |     |     |      |      |              |              |  |
|------------|-----------|-------------|------|------------------|----------|---|-------------------------|-----|-----|------|------|--------------|--------------|--|
|            |           |             |      |                  |          |   | 0                       | 0.3 | 0.6 | 0.8  | 1.1  | 1.4          | 1.6          |  |
| 230V       | 380V      | KW          | HP   | 1Ph 230V         | 3Ph 380V |   | 0                       | 1   | 2   | 3    | 4    | 5            | 6            |  |
| JTB-3/05M  | JTB-3/05T | 0.55        | 0.75 | 4.6              | 1        | 1" x 1"                                 | TOTAL HEAD IN METRES    |     |     |      |      |              |              |  |
|            |           |             |      |                  |          |   | 36                      | 32  | 24  | 19   | 14   | 12 (4.5m³/h) | -            |  |
| JTB-3/07M  | JTB-3/07T | 0.75        | 1    | 5                | 1.6      | 1" x 1"                                 | 44                      | 37  | 31  | 24.5 | 18   | 15 (4.5m³/h) | -            |  |
| JTB-4/11M  | JTB-4/11T | 1.1         | 1.5  | 7.5              | 2        | 1¼" x 1"                                | 47                      | 41  | 38  | 31   | 26.5 | 22           | 20 (5.5m³/h) |  |
| JTB-4/15M  | JTB-4/15T | 1.5         | 2    | 11               | 2.8      | 1¼" x 1"                                | 53                      | 47  | 42  | 37   | 32   | 28           | 21           |  |

In view of continuous developments the information / performance / descriptions / specifications / illustrations are subject to change without notice.

## DIMENSIONAL DETAILS

## JTS SERIES

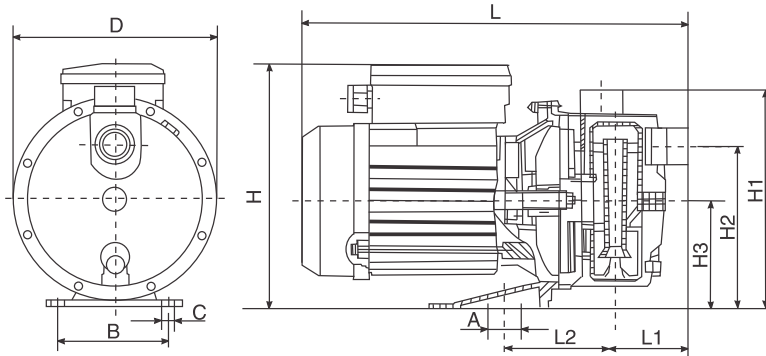

| PUMP MODEL |           | MOTOR POWER |      | A  | B   | C  | D   | H   | H1  | H2  | H3  | L   | L1 | L2  | APPROX. NETT WT IN Kg |
|------------|-----------|-------------|------|----|-----|----|-----|-----|-----|-----|-----|-----|----|-----|-----------------------|
| 230V       | 380V      | kW          | HP   |    |     |    |     |     |     |     |     |     |    |     |                       |
| JTS-2/03M  | JTS-2/03T | 0.37        | 0.5  | 7  | 100 | 7  | 170 | 195 | 161 | 128 | 88  | 365 | 88 | 109 | 7.6                   |
| JTS-3/05M  | JTS-3/05T | 0.55        | 0.75 | 20 | 98  | 10 | 184 | 202 | 203 | 148 | 98  | 354 | 80 | 80  | 9.8                   |
| JTS-3/07M  | JTS-3/07T | 0.75        | 1.0  | 20 | 98  | 10 | 184 | 202 | 203 | 148 | 98  | 354 | 80 | 80  | 10.3                  |
| JTS-3/11M  | JTS-3/11T | 1.1         | 1.5  | -  | 98  | 10 | 198 | 236 | 212 | 160 | 105 | 417 | 97 | -   | 11.8                  |

\* All Dimensions are in mm.

## JTB SERIES

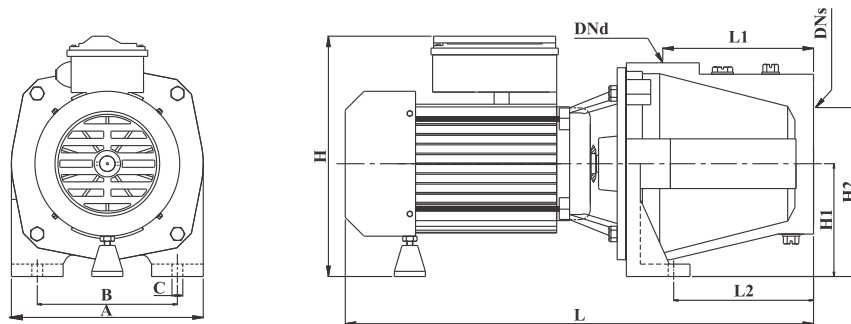

| PUMP MODEL |           | MOTOR POWER |      | Dns    | Dnd | DIMENSIONS IN mm |     |     |     |     |    |     |     |     | APPROX. NETT WT IN Kg |
|------------|-----------|-------------|------|--------|-----|------------------|-----|-----|-----|-----|----|-----|-----|-----|-----------------------|
| 230V       | 380V      | kW          | HP   |        |     | L                | L1  | L2  | A   | B   | C  | H1  | H2  | H   |                       |
| JTB-3/05M  | JTB-3/05T | 0.55        | 0.75 | 1"     | 1"  | 440              | 150 | 230 | 180 | 140 | 9  | 100 | 150 | 200 | 15                    |
| JTB-3/07M  | JTB-3/07T | 0.75        | 1    | 1"     | 1"  | 440              | 150 | 230 | 180 | 140 | 9  | 100 | 150 | 200 | 19                    |
| JTB-4/11M  | JTB-4/11T | 1.1         | 1.5  | 1 1/4" | 1"  | 530              | 160 | 285 | 200 | 160 | 10 | 120 | 165 | 240 | 15.5                  |
| JTB-4/15M  | JTB-4/15T | 1.5         | 2    | 1 1/4" | 1"  | 530              | 160 | 285 | 200 | 160 | 10 | 120 | 165 | 240 | 16.5                  |

\* All Dimensions are in mm.